

ALUMINIUM AND STEEL JUNCTION BOXES

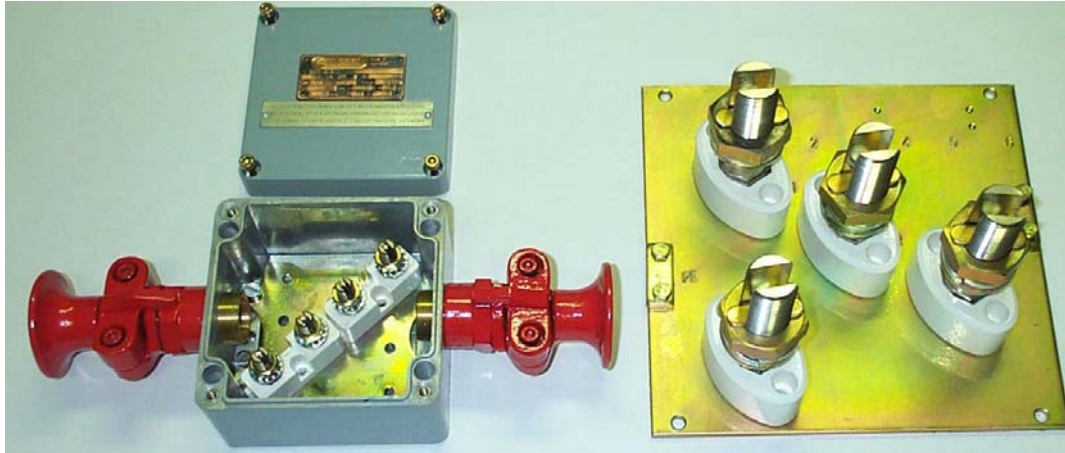

Technical data

Type	PV-..
Certificate	USM - Ex 940265 - 940293
Type of protection	Exe II T5 , Exe I
Degree of protection	IP 54
Material	PV-01R aluminium, other steel plate

Connection terminals – max number of conductors (mm²)

	Solid wire	Multi wire	Stranded wire		Solid wire.	Multi wire	Stranded wire		Solid wire	Multi wire	Stranded wire.
	/	2 x 16	2 x 16		/	2 x 70	2 x 70		3 x 95	3 x 95	3 x 95
	3 x 10	3 x 10	3 x 10		3 x 50	3 x 50	2 x 50	PN 120	4 x 70	4 x 70	4 x 70
PN 16	4 x 6	3 x 6	3 x 6	PN 70	4 x 35	3 x 25	3 x 35	330A	5 x 50	5 x 50	5 x 50
80A / 660V	5 x 4	4 x 4	4 x 4	225A	5 x 25	4 x 25	4 x 25	660V	6 x 35	6 x 35	6 x 35
	6 x 2,5	5 x 2,5	5 x 2,5	660V	6 x 16	6 x 16	6 x 16	PN 120/1	7 x 25	7 x 25	7 x 25
	/	3 x 185	3 x 185					330A			
PN 185	/	4 x 150	4 x 150					1000V			
440A /660V	3 x 120	5 x 120	5 x 120								

Dimensions

Type	A	B	C	A1	A2	B1	B2	Plate for cable entries			
								TSL-0	TSL-1	TSL-2	TSL-3
PV-01R	120	/	85	/	/	122	/	/	/	/	/
PV-1R	315	240	195	280	350	200	205	2x	/	2x	/
PV-2R	365	315	210	230	400	280	220	/	/	4x	/
PV-3R	485	315	210	350	520	280	220	/	/	2x	2x
PV-4R	725	315	210	590	760	280	220	/	/	4x	/

Dimensions:

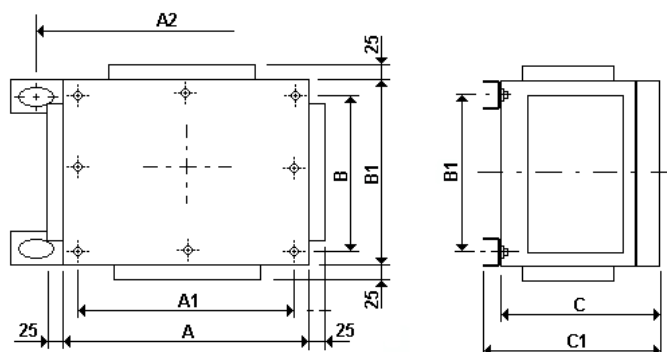

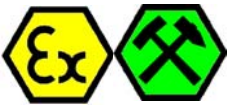

Planning details for enclosures

Type of enclosure	Connection terminals		Rated current (A)	Max. number of cable entries in one side		
	Type	Max. no.		Re	A/B	C/D
PV – 01R	PN 16	4	80	7	4	4
				9	3	3
				11	2	2
				13,5	2	2
				16	1	1
				21	1	1
				29	1	/
				36	/	/
PV – 1R	PN 16	12	225	16	6	3
	PN 70	4		21	6	2
				29	4	1
	PN 70+PN 16	4+4		36	3	1
				42	2	1
				48	2	1
	64	2		/		
80	2	/				
PV – 2R	PN 16	24	260	16	6	6
	PN 70	8		21	6	6
	PN 120	4		29	4	4
	PN 120/1	4		36	3	3
	PN 120 + PN 16	4+6		42	2	2
	PN 120/ + PN 16	4+6		48	2	2
	64	2		64	2	2
	80	2		80	2	2
PV – 3R	PN 16	36	370	16	11	6
	PN 185	4		21	9	6
				29	7	4
	PN 185 + PN 16	4+4		36	5	3
				42	7	4
				48	3	2
	64	2		64	2	2
80	2	80	2	2		

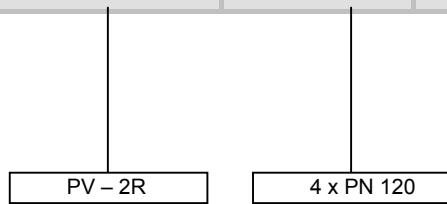

Order example:
 PV - 2R - 4 x PN 120
 Cable entries: side A – 1x Pg 42
 side B – 1 x Pg 42

Entries:

