

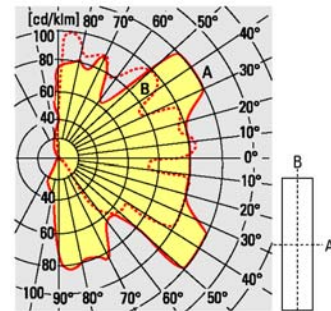

# WALL / CEILING LIGHT FITTING



## Technical data

Type	1789
Certificate	IBEXU 03 ATEX 1113
Type of protection	EEx de IIC
Temperature class	T3
Degree of protection	IP 65
Insulation class	I
Rated voltage	250 V
Rated current	4 A
Lamp	max. 100 W
Weight	4,0 kg
Cable entries	1 x M25x1,5 , 1 x plug M25x1,5
Ambient temperature	-20 °C to +40 °C

## Temperature class

Temperature class	Incandescent lamp
T1 230 V	100 W *
T2 230 V	40 W *
T3 230 V	25 W

## Dimensions

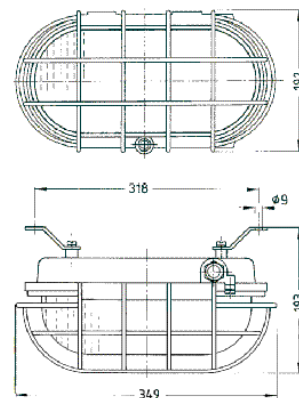

\* At mounting must to consider certification instructions